

C-RAIL-HOOK-BASE-ADAPTER Angle Mounting Bracket for Hook-A

The C-RAIL-HOOK-BASE-ADAPTER is a vital component of the unique, corrugated “C” shape-based C-RAIL-MESSENGER system, designed specifically for optical fibre-based aerial access networks.

The C-RAIL-HOOK-BASE-ADAPTER (1) is a stainless metal sheet product. It is designed to support the construction of the C-RAIL-HOOK-A kit on poles located on steep hills. The angle mounting bracket turns the position of the C-RAIL-HOOK-BASE (2) 25° upwards. This reduces the breaking angle between the Hook (3) and the Anchor (4).

The angle mounting bracket is used at locations with a steepness or a gradient exceeding 15 degrees (equals approximately 17%). The adapter can be used at steepnesses or gradients up to 40 degrees (equals approximately 84%). It has to be fixed onto the pole with a stainless steel band.

The requested band width is 19,06 mm (3/4”). The recommended tensile strength is 5 kN.

NO GROUNDING PROCESS NEEDED

All components are made from dielectric materials (PA6 und PA6GF30). Some of them are reinforced with glass fibre additives. This allows the applicability of the product on 0,4 kV energy poles without the need of a time-consuming and costly grounding process.

FAST AND SIMPLE INSTALLATION

The product is designed to allow for an extremely fast and simple installation process even at the top of the poles. The usual time of installation is less than 10 seconds.

In order to maximise the pulling ability of the embedded ultra-compact optical cable, the bracket fixes the messenger in one pole position where the open part of the C-RAIL-MESSENGER is facing upwards.

PRODUCT DETAILS

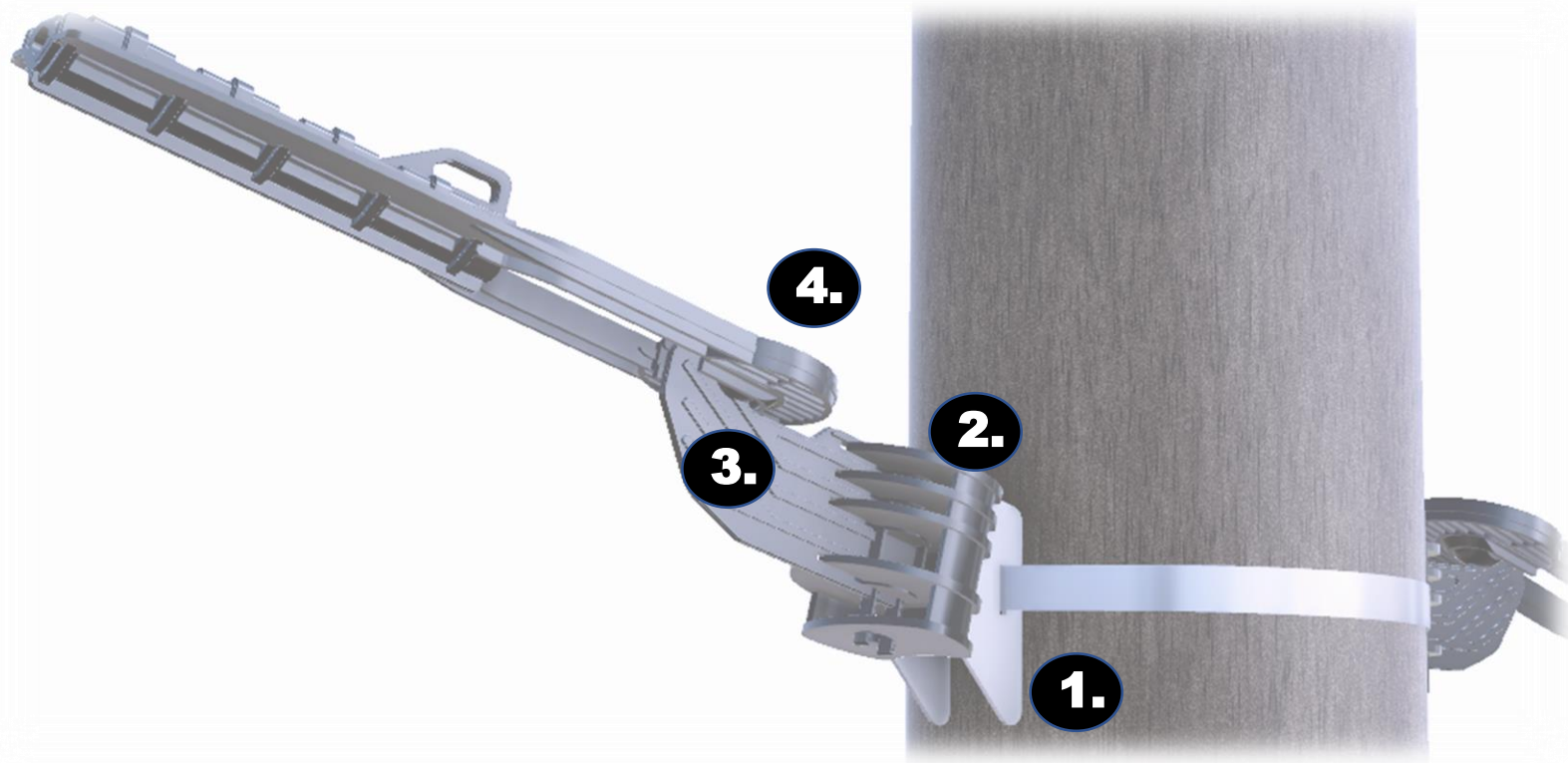

Kit contents

C-Rail-Base Holding Plate	1 pc.
Countersunk head socket screw M5/15mm/A2	1 pc.
Clamping Plate	1 pc.

Product information

Net weight	0,17 kg per kit
------------	-----------------

Dimensions

b: 50 mm

h: 88 mm

d: 45 mm